

PERMISSIVE ACCESS

On this permissive walk notice the grassy areas, these are sown with clover mixes to attract bees and birds.
Please keep your dogs on a lead to avoid birds being disturbed at all times.

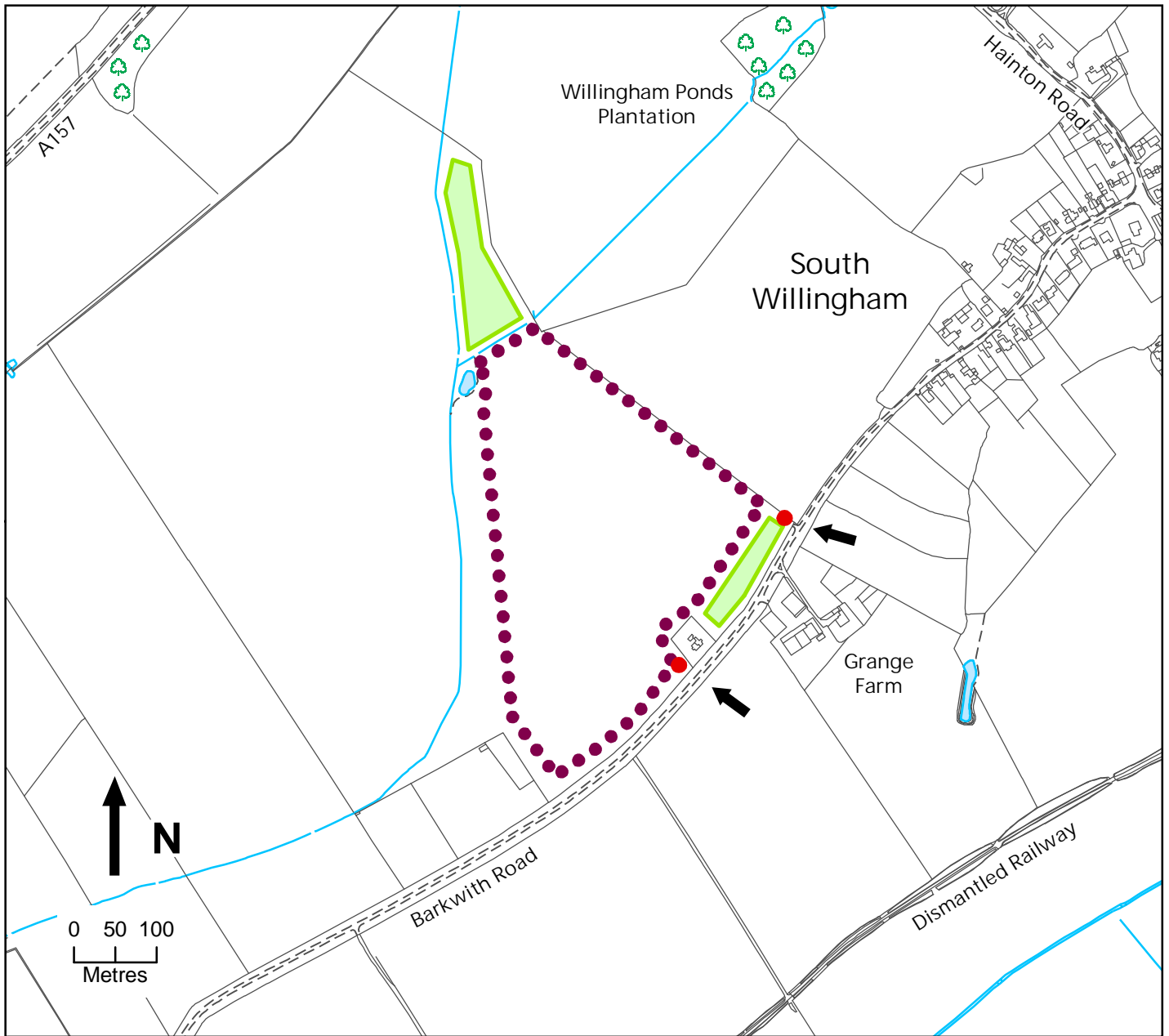

Grid Ref	TF 188 828		Entry/exit point		Permissive Footpath
Ref Nos	AG00301707 24/845/0005		You Are Here		Clover Mix

This access has been provided under the Department for Environment, Food & Rural Affairs' farm conservation schemes as managed by Natural England, which help farmers and land managers protect and improve the countryside, its wildlife and history. It is permissive access and no new rights of way are being created. Existing rights of way are not affected. Please follow the Countryside Code and observe any other requirements shown above. Do not disturb wildlife, livestock or other visitors and in particular keep dogs under control. This is working farmland so please take care; people using this site do so at their own risk. Access ends on 31st March 2020.

For access related queries please call the Environmental Stewardship Permissive Access Team on 0300 060 1114 (Office Hours).
For all other Defra related queries please contact the Defra Helpline on 08459 335577 (Office Hours).

Reproduced by permission of Ordnance Survey on behalf of Her Majesty's Stationery Office, © Crown copyright and database right 2010. Unauthorised reproduction infringes Crown Copyright & may lead to prosecution or civil proceedings. Natural England licence No. 100022021, 2010. The depiction of rights of access does not imply or express any warranty as to its accuracy or completeness.



ENVIRONMENTAL
STEWARDSHIP

COUNTRYSIDE
STEWARDSHIP

ENVIRONMENTALLY
SENSITIVE AREAS